

MAGNETIC DISPLACEMENT MEASURING INSTRUMENT

磁性位移测量仪

MA10E

- 显示分辨率：10um, 50um, 100um, 1mm
Display resolution : 10um, 50um, 100um, 1mm
- 重复测量精度：Max 10um
Repeated measurement accuracy: Max 10 um
- 多功能菜单，可自由设定参数
Multifunctional menu, are free to set parameters
- 高亮数码管显示
Highlighting the digital tube display
- 按键/菜单锁
Lock button/menu
- 公制/英制可切换
Metric/inch swappable
- 长度/角度测量模式
Length/Angle measurement model
- 绝对/相对测量模式
Absolute/relative measurement model
- 非接触式测量，无磨损
Non-contact measurement, no wear and tear
- 防护级别高，抗油污，抗灰尘
High level of protection, oil resistance, resistance to dust
- 更换电池便捷
Replace the battery is convenient
- 卡式外壳，安装便捷
Cassette case, installation is convenient



特性 features	技术参数 Technical parameters	备注 Notes
测量参数 Measurement parameters		
系统精度 System accuracy	$\pm (0.03+0.01*L)$ mm	L单位为：米 Unit: m
测量/显示范围 Measurement/display range	-999999 ~ 9999999	
显示分辨率 Display resolution	0.01/0.05/0.1/1	单位为：毫米 Unit: mm
移动速度 Movement speed	Ma x 5m/s	
结构参数 Structural parameter		
外观尺寸 Outward appearance size	见右图 See right	单位为：毫米 Unit: mm
外壳材料/颜色 Housing material/color	ABS+PC 灰色 ABS+PC Grey	
传感器线长度 Sensor cable length	1米 1 m	可按需订制 Customized on-demand
重量 Weight	约0.45Kg About 0.45Kg	
其他参数 Other parameters		
后备电源 Backup power supply	2节AA 1.5V Section 2-AA 1.5V	5号电池 5th battery
电源供电 Power supply	直流9~24V 10mA 9~24V DC 10mA	
适用的磁尺 Applied magnetic ruler	MS 500/5mm	
工作温度 Working temperature	-10°C~+60°C	
储存温度 Storage temperature range	-30°C~+80°C	
防护等级 Protection rating	IP54前面板 IP67传感器 IP54 front panel an IP67 sensor	
抗震性能 Seismic performance	10g(5~100HZ)	DIN IEC68-2-6
抗冲击性 Impact resistance	30g/15ms	DIN IEC68-2-27

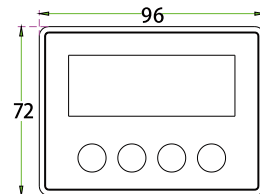

正视图
Front view

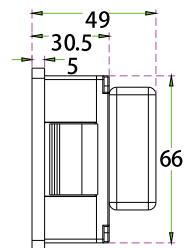

侧视图 1
Side view 1

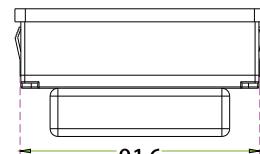

侧视图 2
Side view 2

(安装和调试要点，详见产品说明书)

(Installation and commissioning, see product specifications)